

REVISION												
NO.	CHANGE CONTENTS						CHANGE CAUSE					

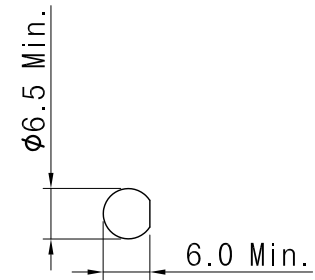
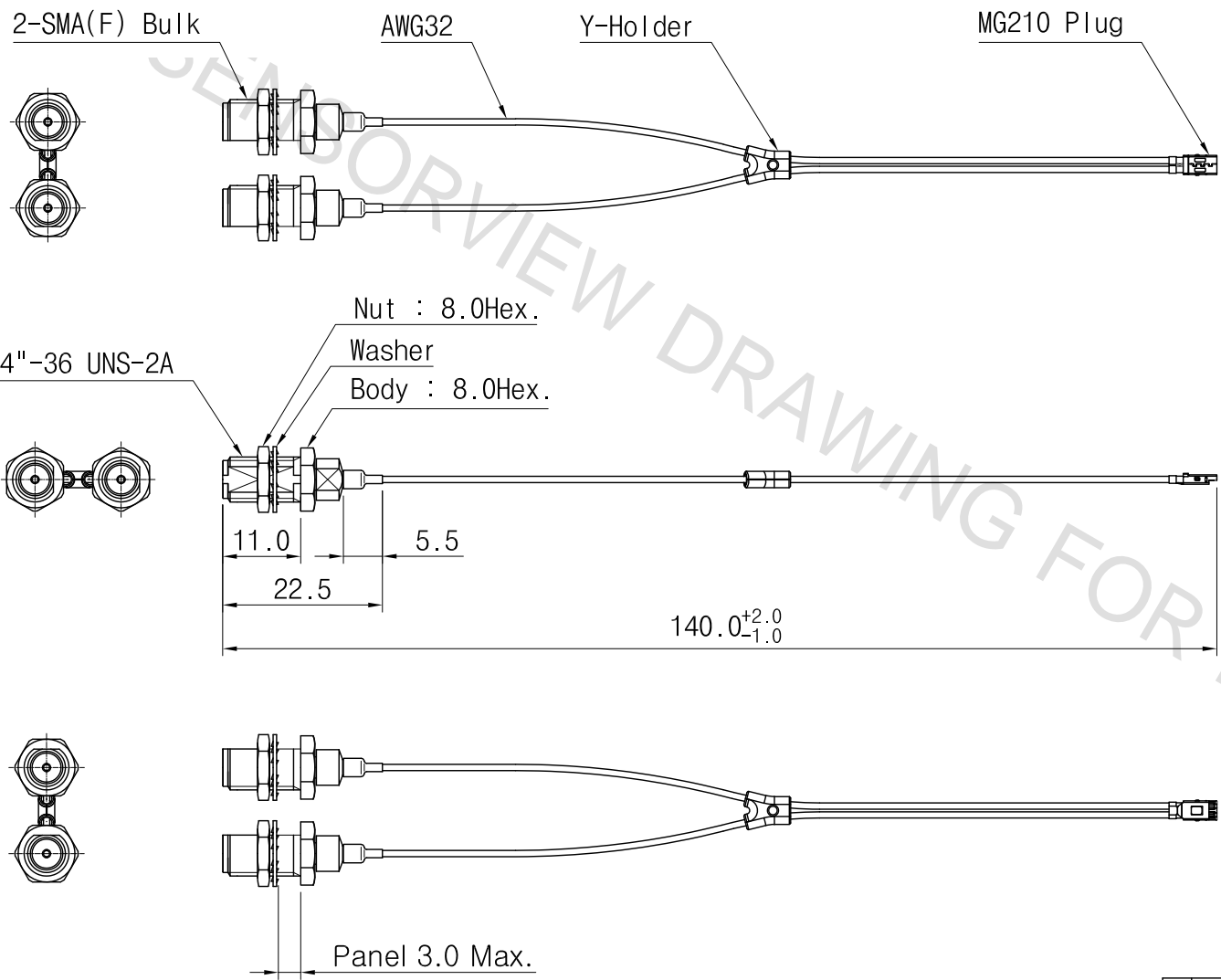

SMA Female Bulk D-Cut
Recommended
Mounting Hole

Note.

1. Material
 - 1-1. SMA(F) Bulk
 - Body, Nut : Bs (Au-Plated)
 - Pin : BeCu (Au-Plated)
 - Washer : STS (Au-Plated)
 - Dielectric : PTFE
 - Heat Shrink Tube : PO
 - THIS RECEPTACLE IS PAIRED
 - 1-2. MG210 Plug
 - Body : Zn (Au-Plated)
 - Signal Pin : BeCu (Au-Plated)
 - Shell : STS (Ni-Plated)
 - Dielectric : LCP
 - Y-Holder : PA
 - ※ This plug can be mated to MG210RE02(Receptacle)
2. Electrical
 - 2-1. Impedance : 50Ω Nominal
 - 2-2. Frequency : DC to 10GHz
 - 2-3. VSWR : 1.5 Max.
 - 2-4. Insertion Loss : -1.5 dB Min.
 - 2-5. Crosstalk : -40 dB Max.
3. Torque : Nut 1.3~1.4Nm



NO.	PART NO.	DESCRIPTION	Q'TY	MATERIAL	REMARKS	REV.
MATERIAL	N/A	DRAW	DESIGN	CHECK	APPRO.	TITLE
FINISH	N/A	L.S.H		Charlie		SMA(F) Bulk / M-Conflon G2(P) for AWG32 (140mm)
TOLERANCE	Decimal	Angle	02/25	02/25	PART NO.	TRA2PA5
SCALE	1/1	UNIT mm	MODEL		SENSORVIEW A3	
REVISION	00	SHEET 1/1				